

Image

The Inglis Newsletter

FALL
2014

inglis.org



IN THIS ISSUE

Inglis Launches
New Brand Identity

Construction
begins on the
Wellness and
Rehab Center

Mission Green Opens

Inglis Artists
at Philadelphia
Museum of Art

Wells Fargo
Partners
with Inglis



**IMAGE has a
new image!**

Inglis is launching
a new look for our
newsletter!

Check it out!



**Ability &
Independence.
Redefined.**

Volunteer Spotlight

Needlework Guild of America Spreads Warmth to Inglis Housing Residents



Residents of the Inglis Housing Corporation apartment communities at Germantown, Elmwood, and Washington Lane were delighted to receive new linens donated by the Needlework Guild of America's Concordville branch this fall. The Guild provided 60 families with brand new comforters and sheets in colors and patterns for every taste. "The children were so happy that they actually wanted to go home and take a nap—probably a first," says Virginia Booth, Inglis Housing Manager. "Some residents even commented that they wanted winter to come so that they could snuggle under their new blankets...others said, 'No, not after the winter we just had!' We all laughed together."

Inglis consumers are long-time beneficiaries of the Needlework Guild. Based in Warminster, PA, the Guild improves quality of life for Americans by collecting and distributing donations of new clothing, linens and personal care items to those in need. For more information about the NGA, visit their website, www.nga-inc.org.

Inglis volunteers enrich the lives of our community in many ways.

Last year, **1,242 volunteers** contributed more than **19,271 hours** representing **10 full-time employees!**

For more information about volunteering, please contact Michael Kelly, Volunteer Coordinator, at 215-581-0718 or michael.kelly@inglis.org.



Table of Contents

New Wellness and Rehab Center at Inglis House	4
Move-in day at Mission Green	5
For Reliant Senior Care team, success means giving back	6-7
Inglis artists display sculpture at Philadelphia Museum of Art	8
Inglis honors supporters at Patrons' Reception	9
Inglis residents go for gold at Keen Games	10-11
Inglis resident "makes a wish" and meets Lady Gaga	12
Kevin Kelly receives Lifetime Achievement Award	12
Betty Marmon honored by the Association of Fundraising Professionals	13
Inglis Artists showcased at Bryn Mawr Presbyterian	13
With thanks to our 2013-2014 Donors	14-18
Inglis Holiday Wish List	19

INGLIS

2600 Belmont Avenue
Philadelphia, PA 19131
inglis.org

Main Number: 215-878-5600

TDD/TTY Number: 215-878-5337

Toll-Free Number: 866-2-INGLIS (866-246-4547)

info@inglis.org

admissions@inglis.org

careers@inglis.org

community@inglis.org

development@inglis.org

drinkaide@inglis.org

housing@inglis.org

volunteer@inglis.org

Cover: *Inglis resident Barry Horton, and Inglis volunteer, in the Parade of Athletes at Inglis' 2014 Keen Games*



In this issue, Inglis unveils its new brand and a corresponding new look for *Image*.

Our new format allows us to highlight Inglis' stories with larger photos, reader-friendly type and a crisp, new design.

First and foremost, the new *Image* is about members of the Inglis Community and the services that allow them **"to live life to the fullest"** – defined not by their disability, but by who they are as individuals.



In this issue, you'll see how Ashley Murphy-Moore, an Inglis House resident, recently enjoyed an hour-long meet-and-greet with Lady Gaga. You'll also share in the joy experienced by Alexi Zentner as he moved into a fully accessible apartment in our newly constructed housing development, Mission Green. From the construction of our Wellness and Rehab Center in Inglis House to the new housing initiatives that will help meet a growing need for accessible, affordable housing for people with disabilities, Inglis is helping people with complex physical disabilities achieve new levels of ability and independence every day.

In this edition of *Image* we also acknowledge the dedicated donors who make this work possible. In a time when shrinking Medicare and Medicaid dollars inadequately cover even the very basics of care, your generous support enables Inglis to continue to provide quality, person-focused care and services, incorporate advances in technology that can help people with disabilities enjoy greater independence, and pursue cutting-edge opportunities to meet the needs of today's disabled community. Thanks to our donors, Inglis is able to redefine itself beyond what Medicare and Medicaid will pay for, and adapt our services to make them relevant for people with disabilities today—and tomorrow.

Providing care and services that make it possible for those we serve to reach new levels of ability and independence drives everything we do. We hope it's also what motivates you to learn more about Inglis, volunteer your time and become a donor. Thank you for your continuing support as we endeavor to share our work and stories with our many constituents. And if you'd like, we invite you to tell us how you feel about the new *Image* at info@inglis.org.

Sincerely,

A handwritten signature in blue ink, appearing to read 'Lauren DeBruicker'.

Lauren DeBruicker, Esq.
Chair, Inglis Foundation

New Wellness and Rehab Center takes shape at Inglis House

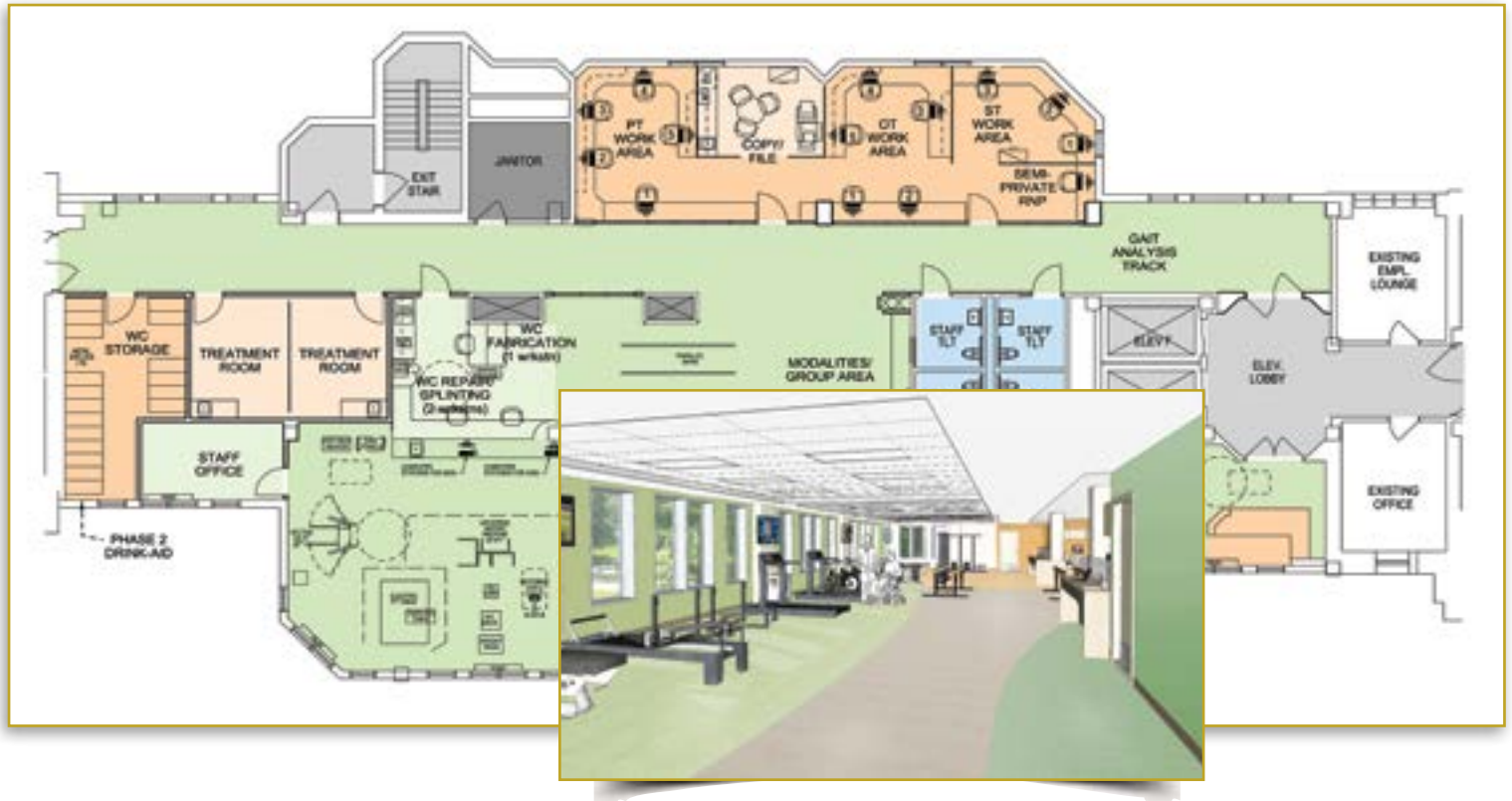

Construction on the new Inglis Wellness and Rehab Center

has begun and will be completed next year. The new Center will be located on the first floor of the Therapy Building.

This new Center is made possible thanks to the generous support of The Pew Charitable Trusts, Hess Foundation, Reliant Senior Care, and the 2013 and 2014 Inglis Golf Outings. We are grateful for these transformational gifts to the Inglis Community!

Inglis' former gym space was overcrowded and had become inefficient through the years as equipment and treatment areas were randomly added. In addition, staff were spread out over two floors. In the new gym, physical, occupational, speech and restorative therapists will share the same space, fostering even greater communication and collaboration among the disciplines.

The new Center will feature a spacious open concept gym area filled with natural light. Flooring will be patterned in non-skid materials to lead visitors through the space in a welcoming way.

A color palette has been chosen to create a calm, light and healthy environment. It is designed with clean lines and new, upgraded equipment including upper body machines, Pilates, weight machines and cycles. Also included is a space for wheelchair repairs and customization, as well as a reception area, private treatment rooms and staff offices. Wellness programming on nutrition, stress reduction, weight loss and other lifestyle topics will be exciting new additions. Look for more about the new Center, along with more information about the generous donors who made it possible, in the Spring issue of *Image*.



Alexi Zentner, former Inglis House resident, was among the first to move into a new, accessible apartment at Mission Green in Abington Township, PA, last month.

On hand to welcome Alexi were (left to right) Property Managers Virginia Booth and Nakia Parker, and Community Systems Coordinator Janice Matthews.

Move-in day at Mission Green

Mission Green, which consists of 61 apartments, is a project of Inglis and the Medical Mission Sisters.

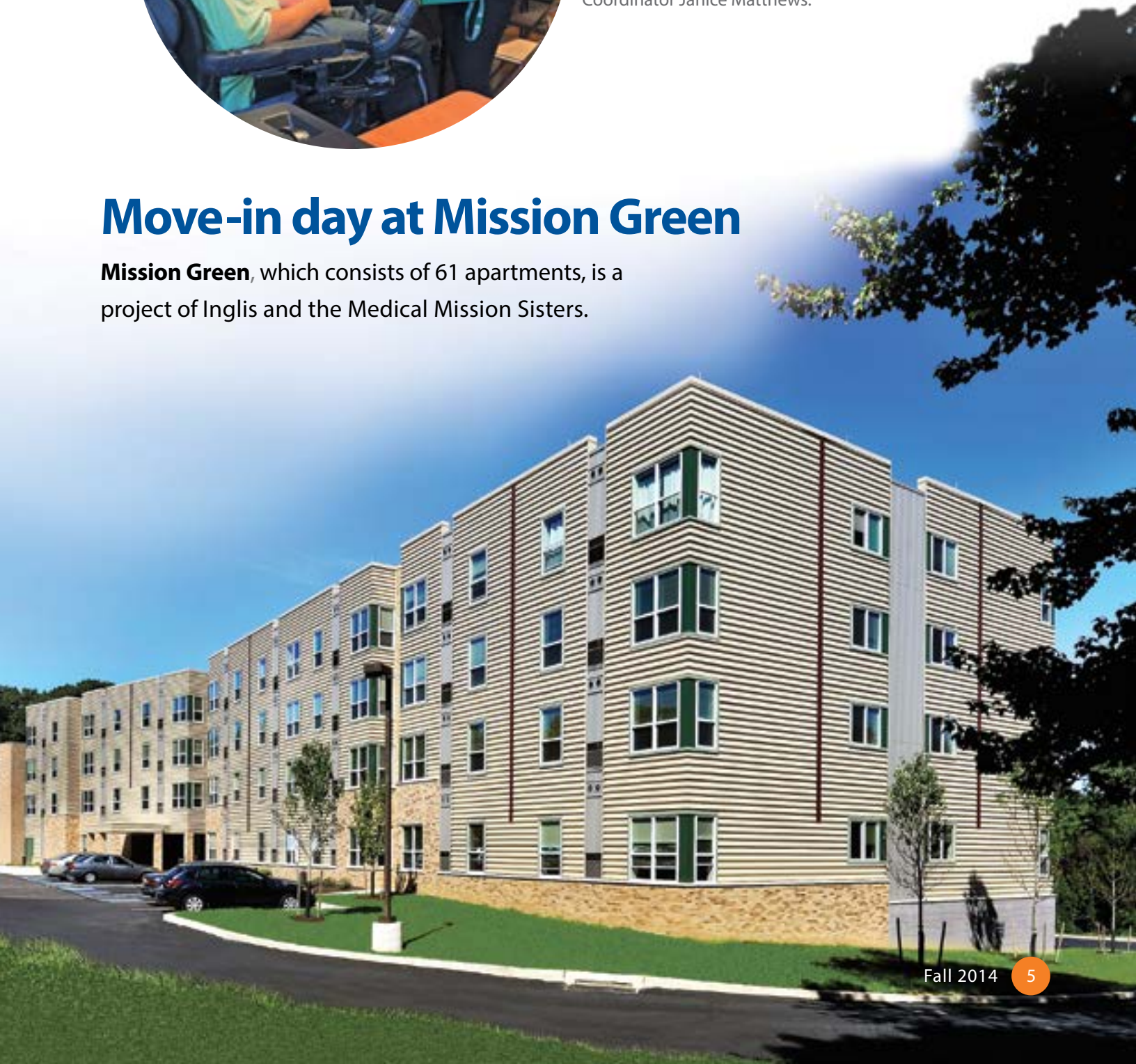

Philanthropy In Action

For Reliant Senior Care team,
success means
giving back





Instilling community involvement: Nate Niles (left center) and Tony Ferrante (right center) encourage other Reliant Senior Care executives to be civic-minded. In addition to acting as Presenting Sponsors of the 2013 and 2014 Golf Outings and bringing colleagues along to enjoy the day, they sponsor youth athletic activities in which their employees are involved.

Growing up in Upper Darby, PA, Tony Ferrante learned to appreciate the values of hard work and giving back to the community. Generosity was ingrained into him at a young age and has been a powerful motivator ever since. “Every day I feel gratitude for the abundance that’s in my life,” says Tony, who owns Reliant Senior Care. “I never want to take it for granted.” This belief is shared by Tony’s business partner, Nathan Niles, President and CEO of Reliant.

Tony and Nate’s association with Inglis began in 2005. Each year since then, they have stepped up to be major supporters of Inglis events. Both serve on the Inglis Golf Outing Committee and were Presenting Sponsors of the 2013 and 2014 Inglis Golf Outings. This year, in addition to their sponsorship, they donated an additional \$75,000 to fund the Inglis Wellness and Rehab Center, on top of the funds the Golf Outing raised. They will also serve as Presenting Sponsors of the 2015 Golf Outing.

“We’re committed to Inglis because we see the way the organization has helped people live better lives,” says Nate. “We also know that with its longevity, Inglis will endure. We feel confident that our contributions will live on for many years to come.”

Both executives agree that their relationship with Inglis has been tremendously satisfying. “We could not have imagined how rewarding this experience has been,” says Nate. “We’ve seen how Inglis House residents help to run operations

and affairs there, with some going on to live independently in the community. These things are what motivate us to remain involved at Inglis. Plus, Gavin Kerr’s commitment is palpable and inspires us to be committed too.”

“The kind of lives we envision for our consumers could never happen without people like Tony and Nate,” says Inglis President and CEO Gavin Kerr. “Their passion for our mission truly touches many at Inglis.”

◀ *Tony Ferrante, owner of Reliant Senior Care, is busy investing in and growing the company—the largest family of senior residential and rehabilitation facilities in the state of Pennsylvania. However, he always makes the time for philanthropic work at Inglis.*



Left to right: Shelley Van Scoyoc, Therapeutic Recreation Instructor Amy Heeter, Artist-in-Residence Rhoda Kahler, Deborah Ulmer, Craig Stephens, Mindy Orth-Stephens, Jacqueline Scott, CNA Brianna Poole, and Ty Klug.

Inglis artists display sculpture at the Philadelphia Museum of Art

Inglis artists were again invited to participate in the Philadelphia Museum of Art's **Bridges: Accessible Programs Builds Partnerships**. The program builds a bridge through visual art, and enables those overcoming adversity to create works of art in their studios and exhibit them in the Museum's Education Corridor.

Inglis artists worked with Rhoda Kahler, Inglis' artist-in-residence, to create a collaborative art piece inspired by the works of Constantin Brâncusi. Participants studied the works of the artist at Inglis as well as on a docent-led tour through the Philadelphia Museum of Art, which holds the largest collection of Brâncusi sculptures in the United States. The tour enabled the residents to understand the artist and his inspiration, which informed the piece they created.

Rhoda chose to introduce the participants to abstract art to

give the residents with limited hand control more confidence in their art work, "I wanted the students to focus less on their ability to control, for example, a brush, and appreciate the beauty and inner soul of the object they were creating," she says.

"In abstract art, a tree doesn't

have to resemble a tree to actually be a tree." The eight-foot ceramic sculpture created by Inglis artists is configured like a totem pole and is titled "After the Essence." The Inglis artist-in-residence program is funded by a grant from Dolfinger-McMahon.

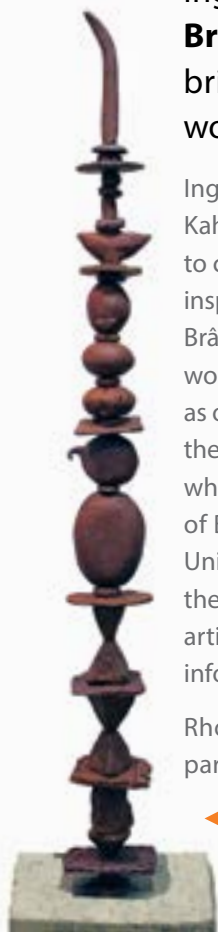

◀ The sculpture, which will be permanently installed at Inglis for all to enjoy, was created in the Emerging Arts Program.



Current and former board members viewed the sculpture on exhibit at the Museum. Front row, left to right: Dixie Wigton, Janet White, Lauren DeBruicker, Gale Gillespie, Emily Riley and Rhoda Kahler, Inglis' Artist-in-Residence. Second row, left to right: Nancy Kirby, Mary Lee Stallkamp, Gavin Kerr, and Sankey Williams.

Inglis honors supporters at Patrons' Reception

This year's Patrons' Reception, celebrating those who help Inglis help others, was held in Founders' Hall on September 30, 2014.

The event provided an opportunity to share our new brand, "Ability & Independence. Redefined." with our donors, advocates and volunteers. Inglis also honored the generous donors that enable us to offer a wide variety of Social Enrichment Programs supported by The Ability Fund such as the Emerging Arts Program, therapeutic gardening, and various resident trips, guest speakers and concerts. These programs give residents a meaningful outlet to express themselves through various forms of visual art, poetry and music.

Featured Speaker: Ty Klug

At the Patrons' Reception guests heard from Ty Klug, a new resident and member of the Inglis Community, who spoke about what the words *Ability* and *Independence* mean to him. Before coming to live at Inglis House, Ty, a Michigan native, worked as an Executive Chef and served in a 10-month program for AmeriCorps. He is also a talented artist, poet and comedian who has the ability to lighten any mood and bring smiles to everyone around him. Ty is just one of the amazing people Inglis serves every day. Since moving to Inglis this spring, he has been involved in many of the Social Enrichment Programs and opportunities to enhance his independence, that are made possible by our generous donors. "My independence would not be possible without the assistance of the physical and occupational therapists at Inglis," said Ty.

"Inglis House is a phenomenal place to shed 'I can't' and find solutions."



Left to right: John Prince, Board member Tim Mahoney, Marie Logue, Board members Won Shin and Jim Logue, Inglis President and CEO Gavin Kerr, Inglis Board Chair Lauren DeBruicker and Brenda Rogers.



Left to right: Former Board Chair Dixie Wigton, Board member JoAnne Fredericks, Former Board Chair Sankey Williams, MD, and Board member Ted Robb.

▼ *Resident Ty Klug introduces Inglis President and CEO Gavin Kerr.*





The annual Inglis Keen Games

were held September 12-13 and brought together a record-breaking 125 residents and more than 130 volunteers for the athletic competition held at Inglis House. The games are named in honor of former Inglis Board member Alice Lightner Keen, who organized the event to celebrate Inglis House's Centennial in 1976.

Inglis residents go for gold at Keen Games





This year's Games were sponsored by Wells Fargo, who provided more than 30 enthusiastic volunteers to help at the event.

During the two-day event, participants competed in language and problem-solving computer and board games on day one, and athletic games such as free-throw basketball, bowling and Skee-ball, which challenge the residents' stamina, fitness and athletic skills, on day two. Residents practiced all summer for the highly anticipated Games with the Therapeutic Education and Therapeutic Recreation staff.

Gold, silver and bronze medals were presented for each event. Sevell Lincoln was voted Most Courageous Athlete by his fellow residents, and Catherine McKnight won the Most Dedicated Athlete Award. Sincere thanks to our sponsor, Wells Fargo, and the dedicated staff and volunteers who helped make this a special day for the Inglis Community.



Wells Fargo volunteers celebrate before the Keen Games.

▼ *Catherine McKnight (below left) was voted Most Dedicated Athlete of the 2014 Games. She is pictured with Inglis recreation therapist, Sarah Heagey (right).*



Inglis resident “makes a wish” and meets Lady Gaga



Ashley Murphy-Moore asked the Make-A-Wish Foundation for a chance to meet her idol, Lady Gaga, several years ago.

“I more or less forgot about it, especially since I became too old for the Make-A-Wish program,” recalls Ashley.

But Make-A-Wish had not forgotten about Ashley, and this summer, she traveled to Atlantic City for a concert and a one-on-one meet-and-greet with the celebrity that lasted nearly an hour. “I could hardly breathe,” says Ashley. “When she walked in the room, she hugged me. She said, ‘I have heard so much about you and I love you already.’ She is so super nice and personable.”

The pair chatted and looked through a Lady Gaga photo book that Ashley brought with her. Ashley, an artist who lives with muscular dystrophy, also presented her with a stunning portrait she created with Inglis Volunteer Coordinator Mike Kelly. Congratulations Ashley, on meeting your idol and proving that wishes can come true!

Kevin Kelly receives Lifetime Achievement Award

Inglis CFO Kevin Kelly received the *Philadelphia Business Journal's* CFO of the Year Lifetime Achievement Award.

Kevin, who came to Inglis in 2009, began his career at Haskins & Sells (now Deloitte.), and transitioned into real estate as a financial analyst and later, acquisitions manager. In 2002, he joined Complete Health Care Resources as CFO. Under Kevin’s financial leadership, Inglis has maximized its fiscal resources and our ability to help consumers. He has also helped to forge an even more productive partnership between the Board and the management team.

Kevin also serves on the Board of the Pennsylvania Assistive Technology Foundation and is a Trustee of the Pension and Health Benefit Plans of Union Local 1199c.

Kevin Kelly, CFO



Betty Marmon honored by Philadelphia philanthropy association

Betty J. Marmon, Inglis' Vice President of Development and External Affairs, has been named **Fundraiser of the Year** by the Greater Philadelphia Chapter of the Association of Fundraising Professionals.

Betty joined the staff of Inglis in 2009. In her role, she serves as Inglis' primary liaison with donors, foundations, governmental organizations and the disability community. She is committed to serving the disability community with a variety of services and resources. During her tenure, Inglis has grown its contributed income by nearly 60 percent, helping to strengthen the partnership of public-private funding.

Prior to joining the staff of Inglis, Betty served as the Director of Development at the Philadelphia Museum of Art.

Her 40-plus-year career also includes leadership positions at the National Trust for Historic Preservation in Washington, DC; the University of Pennsylvania, Barnard College, Cornell University and the University of Rochester Medical Center. She received her award on Nov. 14, 2014, National Philanthropy Day, at their annual celebration in Philadelphia.

*Betty J. Marmon,
VP of Development
and External Affairs*



Inglis Artists showcased at Bryn Mawr Presbyterian

Works of art created by Inglis residents will be on display at Bryn Mawr Presbyterian Church, 625 Montgomery Ave., Bryn Mawr from January 6 – February 22, 2015. The pieces showcase the wide-ranging talents of our residents and include digital art, sculpture, mixed media and painting.

*Bryn Mawr Presbyterian will host an opening reception for the exhibition on Sunday, January 25th at 3 p.m. Many pieces in the show will be available for purchase, benefitting the artists and the Church. For additional information, contact **Page Zettlemyer at 215-581-0753 or page.zettlemyer@inglis.org.***



The show will include this piece by Inglis resident Ty Klug, entitled, "Sail."

Support for the Inglis Community

Thank you to the following donors who have invested in helping amazing people achieve their goals and live life to the fullest. We are grateful for their support, which strengthens the Inglis Community today and for years to come. This report includes contributions received from July 1, 2013 to June 30, 2014.

\$100,000+

Capital One
Estate of Lewis Elkin
Hess Foundation, Inc.
Estate of Emilie J. Klahr
Estate of Muriel G. Reich
Estate of Emma L. Warne
Dr. Sankey V. and The Honorable
Constance Williams

\$50,000+

Estate of Lydia Jones Fitch
Estate of Julia W. Frick
Estate of Katharine L. Jones
The Pew Charitable Trusts
Reliant Senior Care

\$25,000+

Estate of Alexander M. Fox, Jr.
Estate of Rosina Gallagher
Leonard Hastings and
Suzanne Schoff Trust
Estate of Jacob E. Heyl
Mr. and Mrs. David O. Oberkircher
Carl and Ruth Shapiro National Center
for Accessible Media at WGBH

\$10,000+

Airgas, Inc.
Mr. and Mrs. James H. Averil
BAYADA Home Health Care
Mr. and Mrs. James J. Bruder
Oscar H. and E. Ida Iucker
Memorial Fund
Mr. and Mrs. Gavin Kerr+
Estate of Samuel Kilpatrick
Lincoln Financial Foundation, Inc.
Mr. and Mrs. James G. Logue+
Estate of Lillian L. Longstreth
Mr. and Mrs. Peter McCausland
The Philadelphia Foundation
Estate of Louis R. Richards
Mrs. James P. Schellenger+
The Scholler Foundation
William A. and Eugenie Hummel
Sullivan Fund
Trion Group, Inc.
Mr. and Mrs. Raymond H. Welsh
Mrs. Robert W. Wigton, Jr.+
Dr. Jacquelyn M. Zavodnick and
Mr. Jason Homer

\$5,000+

Anonymous (2)
The Addis Group
Lauren E. DeBruicker, Esq.+
Estate of Edward and Mary Dobbins
Dolfinger-McMahon Foundation
Mr. and Mrs. John K. Dugan
Mr. and Mrs. James P. Gaffney
Genuardi Family Foundation
Goshen Mechanical, Inc.
Mr. and Mrs. H. F. (Gerry) Lenfest
Estate of Annie L. Lowry
Estate of Helen M. Lukens
Mr. and Mrs. Timothy J. Mahoney, III
McKesson Medical Surgical
Mr. and Mrs. Matt O'Mara
Mr. and Mrs. R. J. O'Neil
The Pew Fund Capacity
Building Program of the OMG
Center for Collaborative Learning
Ray of Hope International
Foundation LLC
Christopher and Dana Reeve
Foundation
Dr. and Mrs. Bozorgmehr Salim
Katie Samson Foundation
Caroline J. S. Sanders
Charitable Trust No. I
Nadya K. Shmavonian Fund
of The Philadelphia Foundation
Mr. and Mrs. Thomas M. Sibson
Mr. and Mrs. Michael J. Stapler
Stapler Family Fund
Estate of Ralph T. Sterling
The TJX Foundation, Inc.

\$1,000+

Anonymous (3)
Abilita Telecom Consulting
Albert Einstein Medical Center
All4, Inc.
Mr. and Mrs. John R. Bartholdson
Mabel Bayard Fund of the
Philadelphia Foundation
Mr. and Mrs. Thomas L. Bennett
BNY Mellon Asset Servicing
Dr. and Mrs. Richard P. Borkowski
Mr. and Mrs. Thomas A. Bruder, Jr.
Bryn Mawr Trust Company
Marilyn Caras Newman
and Patrick Newman
Mr. and Mrs. Nicholas W. Carper
Mrs. Mary M. Carroll
The Carroll Living Trust

\$1,000+ continued

Louis N. Cassett Foundation
Code Elevator, Inc.
Connelly Foundation
Deloitte.
Estate of Benjamin F. DeLong
Diamond & Associates
Domus Inc.
Duane Morris LLP
Ms. Alysse Einbender
Engle-Hambright and Davies, Inc.
F.P. Woll & Company
Ms. Catherine H. Farrell and
Mr. William Wertheimer
Mr. and Mrs. Paul G. Finegan
Flatiron Building Company
Estate of Samuel Frank
JoAnne T. Fredericks, CFA
Mr. and Mrs. Joseph Frontino
Estate of George A. Garrett
Mr. and Mrs. Bruce Golden
Ms. Juliet J. Goodfriend and
Dr. Marc R. Moreau
Greycourt & Company, Inc.
Mr. and Mrs. William J. Grim
Ms. Geneva Haley
Halfpenny Management Company
Mrs. Samuel M.V. Hamilton
Hamilton Family Foundation
The Haney Foundation Trust
Mr. and Mrs. Ludlow Harding
Ms. Susan Hirsch and
Dr. Noam D. Zelman
Estate of Ann K. Horner
Ms. Virginia Hudecki and
Dr. Evan Frank
Mrs. Ann M. Hunter
Mr. and Mrs. Robert Jacobs
T. James Kavanagh Foundation
Mr. and Mrs. Kevin S. Kelly
Mr. and Mrs. Paul E. Kelly
Paul E. Kelly Foundation
Mr. Francis W. Kling
Mr. and Mrs. R. Andrew Knowlton
Mr. William J. Koons
Ms. Eileen Korey
Mr. and Mrs. William T. Lawrence
Mr. and Mrs. Mariano Leo
Mr. and Mrs. Michael J. Levitt
Michael J. & Patricia Levitt Family
Charitable Foundation
Lincoln Financial Group
Sara Long Trust
Samuel P. Mandell Foundation
Ms. Betty J. Marmon
Ms. Cathy Martell

\$1,000+ continued

McCausland Keen Buckman
Mr. and Mrs. John S. McManus, Jr.
Drs. Carol M. Pate and John Melvin
Mr. and Mrs. Anthony A. Milne
Mobilex USA
Mrs. Linda M. Moore
Moss Rehabilitation Center
National Multiple Sclerosis
Society Greater Delaware
Valley Chapter
Omnicare
ParenteBeard, LLC
Mr. and Mrs. Arthur P. Pasquarella
The Arthur and Gail Pasquarella
Family Foundation
Passover League of Philadelphia
PDS
The Philadelphia Committee of
the Garden Club of America
Mr. David N. Pincus*
Pincus Family Foundation
Mr. and Mrs. John H. Prince+
Mr. and Mrs. Douglas H. Pyle
Regan Development Corporation
Ms. Emily C. Riley
Estate of Joseph G. Rittenhouse, Jr.
Mr. Theodore Robb+
Dr. Marisa A. Rogers and
Mr. Eston Griffin, III
Ms. Suzanne Rotondo
Seymore and Helen Ann Rubin
Foundation
Dr. and Mrs. James K. Seaman
Sherbrooke Partners, LLC
Mr. and Mrs. Won Shin
Skanska USA Building
Joseph Kennard Skilling Trust
Estate of Elizabeth Wandell Smith
Strategic Systems of
New Jersey, Inc.
Mr. and Mrs. Harold C.
Strawbridge, III
Estate of Henry Stuebner
Samuel Tabas Family Foundation
Mrs. Carolynne Bernard Thomas
Edna Thomas Memorial
Charitable Trust
U.S. Foods
United Seating and Mobility
Venture Programs Inc
Mr. and Mrs. John R. Voegele, Jr.
Meredith and Gregory Waldron
Ms. Cheryl Whitfield
Dr. and Mrs. Steven Zavodnick
Drs. Jacqueline S. and Steven Zinn

Support for the Inglis Community *continued*

\$500+

Anonymous (2)
Mr. John Bang
BartonPartners
BKT Architects LLC
Mr. Jeffrey Boyle
Mr. and Mrs. George C. Brady, III
Brookmead Construction
Brown Brothers Harriman & Co.
Caplan Family Charitable Trust
Mr. and Mrs. Felix R. Capobianchi
Mr. and Mrs. C. T. Carroll
Cecil Baker & Partners
Chancy Memorial Foundation, Inc.
Charles Friel, Inc.
CNA Foundation
Comcast Corporation
Comprehensive Health Solutions, P.C.
Mr. and Mrs. Alan Dore
Mr. and Mrs. Michael J. Driscoll
Ms. Justine D. Englert
Mr. and Mrs. Walter Fisher, Jr.
Mrs. Mary Ann Flanigan
Mr. Michael Flynn
Francis J. Atkinson & Sons, LLC
HCSC Laundry
Mr. and Mrs. Thomas E. Hunter
Innovative Software Solutions, Inc.
Mr. and Mrs. John W. Irvine, Jr.
Mr. and Mrs. Aram K. Jerrehian, Jr.
Mr. and Mrs. Edward L. Jones, Jr.
Mr. and Mrs. David Kagan
Ms. Sandra P. Kenton
Ms. Brenda L. Kinnear
Mrs. Anne G. Klaus and Mr. Byron Kline+
The Lancaster Group, LLC
Ms. Catherine L. Larson
Dr. and Mrs. Joseph Loscalzo
Mrs. Louis C. Madeira
Miss Tessa Mahoney
McGrory, Inc.
The Mill Spring Foundation
Mr. Michael Morris
Penn Valley Chemical Co., Inc.
Plumbers Local 690
PMA Insurance Group
RBC Capital Markets
Mr. and Mrs. Theodore A. Rosen
Rhoda and Stephen Sand
Sand Family Fund

\$500+ continued

Mr. Scott A. Sawers
Sellers Dorsey
Ms. Phyllis Chancy Solomon
Ms. Susan F. Starr
State Farm Companies Foundation
Steamfitters Local Union 420
The Emily Sullivan Foundation
The Northern Trust Company
The Pennsylvania Trust Company
Ms. Kristen Thies
Thomas Scattergood Behavioral Health Foundation
Triad Strategies, LLC
United Concordia
United Healthcare Insurance Company
UNUM
Vanguard Charitable Endowment Program
Mr. and Mrs. Robert D. Vernot
Mrs. Frances Vilella-Velez and Mr. Jeffrey W. Golan
Ms. Deborah Holt Weil
Elizabeth McGee-Wood, MD+
Zeldin Family Foundation
Mr. and Mrs. Thaddeus Zettlemoyer

\$250+

Anonymous
Reverend David R. Adam
Ms. Maria Adeyemi
Mr. and Mrs. Paul N. Allen
Mr. and Mrs. Andrew M. Alloy
Ms. Molly Baker
Bank of America United Way Campaign
Mr. George C. Benson
Mr. and Mrs. Gregory E. Bones
Mr. Gary D. Bramnick
Mr. and Mrs. Joseph Brazino+
Bristol Rescue, Inc.
Mr. Anthony J. Brown
Mr. and Mrs. James M. Buck, III
Melvin J. Buckman, Esq.
Mr. Richard A. Campion
The Center For Students Missions Inc.
Mr. and Mrs. John H. Clapham
Mr. and Mrs. William Claypool
Mr. and Mrs. Mark A. Cooper
Mr. and Mrs. Michael J. Dandorpha
Mr. and Mrs. James F. Dever, Jr.
Duane Morris Government Strategies LLC

\$250+ continued

Mr. and Mrs. James B. Flanigan
Mr. and Mrs. Joseph Flanigan
Mr. Marc Forte
Mr. Thaddeus J. Fortin
Ms. Sandra D. Francis
Ms. Mariette Gaul
Mr.* and Mrs. Edward J. Grady
John P. Gregg, Esq.+
Dr. Christopher L. Hansen
Mr. and Mrs. James A. Heding
Mr. and Mrs. Robert F. Henderson
Mr. and Mrs. Gerard A. Hnizdo
Mr. and Mrs. Thomas Huff
Dr. Ben Inglis
Mrs. Melissa Rene Kaseman
Mr. David Keller
Dr. Thomas P. Keon
Mr. and Mrs. Richard E. Knowlton
Mr. and Mrs. John J. Kwartnik
Ms. Grace Laughlin
Laura J. Hornberger Fund
Mr. Vincent Lopez
Mahoney Realty Group, Inc.
Mary and Leroy Marell
Mr. and Mrs. Christopher Marshall
Mr. and Mrs. Edward F. Martin, Jr.
Mr. and Mrs. Lawrence Mathers+
Mr. and Mrs. John L. McDonough
Merck Partnership For Giving
Mr. and Mrs. William J. Miller, III
Ms. Suzie Milord
Mr. and Mrs. Phil Mowrey
Mr. and Mrs. Thomas E. Mowry, Jr.
Mr. Michael A. Panunto, Sr.
Mr. and Mrs. Gary J. Tanner
Mr. James V. D. Quereau
Renaissance Charitable Foundation
Drs. James and Brenda Rogers
Mr. and Mrs. Roy Sale
Mr. and Mrs. Peter H. Sellers
Mr. Michael Sklaroff, Esq.
Ms. Jacqueline M. Smith
Mr. and Mrs. Randy A. Smith
Mr. and Mrs. William J. Stallkamp
Mrs. Andigoni T. Steffa and Family
Mr. and Mrs. Gary P. Tretina
Mr. and Mrs. Carey M. Verger
Lee and Bill Warden
Miriam's Well Fund of the Knoxville Jewish Community Family of Funds
Dr. and Mrs. Clifton F. West, Jr.
Mr. and Mrs. John M. Wilson

\$100+

Anonymous (13)
Dr. and Mrs. Richard P. Albertson
Ms. Sylvia E. Andrews
Mr. and Mrs. Vincent R. Avallone, Jr.
Ms. Maxine Bates
Bevtek, Inc.
Mr. and Mrs. Edwin H. Biron
Mr. Wayne L. Bockelman
Ms. Lea S. Bramnick
Ms. Elizabeth Brooks
Mr. and Mrs. Robert Bryan
Ms. Maureen Burke
Mr. Richard G. Burton
Mr. George A. Butts
Ms. Kathryn Cadwell
Dr. Caryl Elaine Carpenter
Harry S. Cherken, Jr.
Ms. Veronica R. Clark
Mr. and Mrs. Joseph A. Coffey, Jr.
Mr. and Mrs. Woodward W. Corkran, Jr.
Dr. and Mrs. Dennis W. Cronin
Mr. and Mrs. James Curto
Mr. and Mrs. Thaddeus J. Cywinski
Mrs. William M. Davison, III
Ms. Shelby S. DeBruicker
Mrs. Marcia B. Deegan
Mr. and Mrs. Ernest J. Dellheim
Ms. Mary Werner Denadai
Mr. and Mrs. Russell Dobbins
Mr. and Mrs. Michael Doyle
Ms. Louisa C. Dubin
Ms. Linda J. Duckenfield
Mr. Dennis M. Dunphy
Ms. Beverly M. Ebner
Ms. Takeisha Edwards
Mrs. Mildred B. Ellerson
Dr. and Mrs. Charles P. Emerson, Jr.
Enon Tabernacle Baptist Church
Episcopal Church Women
Mr. and Mrs. Nicholas A. Ettore
Drs. Ruth and Barry Farber
Eileen R. Farrell
Ms. Luba Fartuszok
Ms. Linda Abby Fein
Mr. and Mrs. Michael O'S. Floyd
Mr. and Mrs. Gardner P. H. Foley
Mr. and Mrs. Brian G. Fox
Mr. and Mrs. Philip G. Fraley, Jr.
Ms. Lois Frischling and Mr. Gerald Miller

Support for the Inglis Community *continued*

\$100+ *continued*

Mr. Michael Gardner
 Mr. and Mrs. James J. Gaul
 Ms. Nancy J. Gellman
 Miss Gay P. Gervin
 Mr. and Mrs. David Ghee
 Mr. and Mrs. Charles J. Giambalvo, Jr.
 Mrs. Martha Gillin
 Paul and Grace Giordano
 Paul Giordano & Sons, Inc.
 Mr. and Mrs. Lewis D. Gitlin
 Mr. and Mrs. Henry A. Gladstone
 Mr. and Mrs. James Goldstein
 Ms. Allison Goodwin
 Ms. Jean Grasso
 Ms. Eva Gray
 Mr. William Griffin
 Mr. John Grillone
 Mr. and Mrs. David I. Haas
 Ms. Darlene Harris
 Ms. Nancy Harris
 Mr. and Mrs. Robert P. Hauptfuhrer
 Ms. Charlotte K. Heller
 Mr. and Mrs. Michael Hennessey
 Mr. David Himmelreich
 Ms. Randy S. Foster and Mr. Bertram Holman
 Ms. Antionette Howard
 Mr. Bill Jones
 Mr. John G. Jones
 Mrs. Veronica Jones
 Ms. Irene Kalman
 Mr. and Mrs. William M. Kanehann
 Mr. and Mrs. Nooruddin Karsan
 Mr. and Mrs. Bryan Kasema

\$100+ *continued*

Mr. and Mrs. Richard Kasser
 Ms. Mimsye W. Katz
 Katz Senior Services
 Mr. and Mrs. David Kauffman
 Ms. Margaret E. Keenan
 Mr. Joseph X. Kennedy
 Mr. and Mrs. Jim Kircher
 Mrs. Louis Klein
 Mr. and Mrs. Levis Kochin
 Mr. and Mrs. Paul Kranick
 Ms. Deborah Kuhn
 Ms. Deborah A. Larson
 Ms. Julie Laskaris
 Mr. and Mrs. Judson D. Laverell, II
 Ms. Kimberly P. Lawson
 Ms. Barbara A. Lee
 Ms. Jeanmarie Lee
 Rabbi and Mrs. Morton Levine
 Ms. Shanti Lewis
 Mrs. Grace Limaye
 Ms. Margaret H. Manchester
 Ms. Josephine A. Mangano
 Mr. Jeffrey C. Markowski
 Mr. William A. Marron
 Mr. and Mrs. Jay W. Martin
 Ms. Gina M. Mazzulla
 Ms. Ann S. McDevitt
 Ms. Ann H. McDonald
 Dr. John McDonald
 Mr. and Mrs. George C. McFarland, Jr.
 Mr. and Mrs. James R. McFarland, Jr.
 Ms. Monica McGinley+
 Mr. and Mrs. Joseph P. McGoldrick
 McKonly & Asbury, LLP
 Ms. Cynthia L. Miller and Mr. Barry Sagalow

\$100+ *continued*

Mr. Marc D. Miller
 Mr. and Mrs. William Millhollen
 Mr. and Mrs. Ralph Moriarty
 Ms. Pamela Morris-Barnhill
 Mr. Milton J. Moser, Jr.
 Mr. Donald L. Mull
 Mr. John W. Murphy and Mr. Thomas Ayers+
 Mrs. Charles C. Myers, Sr.
 Ms. Judy Nitzky
 Mr. and Mrs. Tom Nordeman
 Thomas J. O'Connor
 Mr. Thomas O'Mara
 Dr. John R. Patterson
 Ms. Lynn Pecora and Ms. Denise Valerio
 Ms. Sharon M. Percy
 Mr. and Mrs. Paul M. Perlstein
 Perlstein Law
 Professional Care Alliance of the Delaware Valley
 Mrs. Patricia Joann Pugh
 Dr. and Mrs. Mario Rafalin
 Ms. Kimberly Okane Robinson
 Mr. Joe Santine and Mrs. Jeri Roma-Santine
 Mr. and Mrs. Steve Rotfeld
 Mr. John N. Rotoli
 Mr. Robert S. Ruane
 Mr. and Mrs. Ronald Rubin
 Ms. Zanetta M. Ruffin
 Schwab Charitable Fund
 Dr. and Mrs. Charles A. Scott
 Mr. and Mrs. Thomas A. Seifert
 Aaron L. Shapiro Trust
 Mr. Irving Sharf

\$100+ *continued*

Mr. and Mrs. Richard J. Sherman
 Ms. Rosalie Sherman
 Ed and Terry Silvey
 Mr. and Mrs. Corey R. Smith
 Mr. and Mrs. Scott R. Smith
 Mr. Jordan Smyth
 Dr. and Mrs. David Sokol
 Sokol Family Foundation
 Mrs. Joseph R. Somers
 Mr. and Mrs. Harry J. Southwell, III
 Ms. Paulette M. Steffa
 Ms. Lorraine E. Stein
 Ms. Ione A. Strauss
 Mr. and Mrs. William Swyer
 Mr. and Mrs. Robert R. Tabas
 Don I. Trachtenberg, DDS
 The Travelers Companies, Inc.
 Sarah Tremells Trust
 Trevoise Heights Rescue Squad
 UBS Matching Gift Program
 Mr. and Mrs. Peter Vetrano
 Ms. Bernadette Vose and Family
 Mrs. Anita B. Walker+
 Mr. and Mrs. John B. Ward
 Ms. Rhoda Weinstein
 Ms. Susan R. Weintraub and Mr. Michael R. Bramnick
 Mr. and Mrs. Marvin A. Welsch
 Mr. and Mrs. John E. Wennogle, Jr.
 Lawrence P. Wennogle, PhD
 Ms. Matla Wiener
 Willow Dale Elementary School
 Mr. Eugene C. Woehr
 Mr. and Mrs. William Wright
 Mrs. Ethel Zavodnick
 + Annie Inglis Society * Deceased

Your gift to The Ability Fund, the annual fund of the Inglis Community, supports these amazing Inglis programs:

- Trips to sports games, restaurants, and cultural activities
- Visual Art Therapy, including Emerging Art Program with an Artist-in-Residence, Weaving, Ceramics and other crafts
- Music Therapy, Resident Choir, Drum Circle and performances by professional performing arts groups
- Theater Workshops
- Volunteer Program
- GED & College-Level Tutoring
- Therapeutic Gardening
- Cognitive Stimulation Intervention Programs
- Resident Literary Journal, Library & E-Library
- Educational presentations from local museums and other groups
- Exercise instruction in Yoga, Tai Chi, Martial Arts, Zumba and more
- Comedy, Film and Book Clubs
- Discussion and Support Groups
- Cooking and Life Skills Classes
- Pastoral Care and Prayer Groups
- Resident birthday parties and large-scale celebrations, like the Harvest Ball, New Year's Eve party, Spring Fling and more

You can help by making a gift today. Use the envelope in the center of

Annie Inglis Society Members

Individuals who include Inglis in their estate plans are recognized as members of the Annie Inglis Society, joining a thoughtful group of people whose largesse has a lasting and profound impact on the organization.

Mr. and Mrs. Joseph Brazino
Ms. Nancy A. Colbaugh
Edgar G. Cross*
Lauren E. DeBruicker, Esq.
Ms. Carolyn J. Elliott
Ms. Antoinette E. Farsaci
Miss Julia W. Frick*
John P. Gregg, Esq.

Smith H. Horne*
Mrs. Neal (Trish) Johnson
Mr. and Mrs. Gordon L. Keen, Jr.
Cindy and Gavin Kerr
Mrs. Anne G. Klaus and
Mr. Byron Kline
Mr. and Mrs. James G. Logue
Mrs. Jorja L. Mathers

Mr. John McClafferty
Ms. Monica McGinley
Mr. Frances E. Middlemore
Mr. John W. Murphy and
Mr. Thomas Ayers
Ms. Elizabeth G. Nathans
Mrs. William F. Nugent
Mr. and Mrs. John H. Prince
Mr. Theodore Robb

Mrs. James P. Schellenger
Helen M. Staron
Mrs. Althea Thierjung
Mrs. Anita B. Walker
Mr. and Mrs. Charles K. White
Mrs. Robert W. Wigton, Jr.
Elizabeth McGee-Wood, MD
Mr. and Mrs. James C. Woolsey

Gifts in Kind

Year-round, Inglis receives gifts in kind that help members of the Inglis Community live great lives.

Anonymous
Adventure Aquarium
Arkema Inc.
Mr. and Mrs. George C. Brady, III
Mr. A. James Brown
Mr. and Mrs. Charles Bush
Dr. Caryl Elaine Carpenter
Ms. Joan Connors
Mr. and Mrs. Mark A. Cooper
Dave & Buster's of Philadelphia
Lauren E. DeBruicker, Esq.
Deloitte.
Ms. Alysse Einbender
Ms. Catherine H. Farrell and
Mr. William Wertheimer
Mrs. Carole Felton
Mrs. Mary Ann Flanigan
Mrs. Miriam K. Fredenthal
Ms. Ruth Ann Fredenthal
JoAnne T. Fredericks, CFA
Mr. and Mrs. Joseph Frontino
Mr. and Mrs. James P. Gaffney
Mr. Thomas J. Giamoni

Gulph Mills Golf Club
Har Zion Temple
Mr. Donald Harmer
Ms. Amy Hartsock
Mr. Charles L. Haub, III
Mrs. Shahidah Hayman
Sui L. Heaven, Esq.
Mr. and Mrs. Harry E. Hill, III
Ms. Lois Hodges
Mr. James Howard
Hugh Wood Inc.
Mr. and Mrs. Neal F. Johnson
JPM Catering and Events
Mr. Eli Kahn
Mr. and Mrs. Gavin Kerr
Ms. Zita L. King
Mr. Bill Kosman
Mr. and Mrs. James G. Logue
Ms. Beth Ann Lorenz
Mr. and Mrs. Timothy J. Mahoney, III
Ms. JoAnne Mann
Mr. and Mrs. Christopher Marshall
Ms. Sandi Matalon

Mr. and Mrs. Joseph T. McDevitt
McGrory, Inc.
Merion Golf Club
NGA, Inc. Concordville Branch
NGA, Inc. Hatboro Branch
PDS
Philadelphia Flyers
Philadelphia Phillies
Philadelphia Smart Set Club
Ms. Lisa Pitkow
PMA Insurance Group
Ms. Nicole Pruitt
Ms. Beverly Risher
Mr. Theodore Robb
Mrs. Ellen Rose
Mr. Bill Salmon
Mr. Michal Schmidt
Sea Glass Fine Art
Dr. and Mrs. James K. Seaman
Mr. Hemant Shah
Ms. Madelyn Sharp
Mr. and Mrs. Thomas M. Sibson
Ms. Lynn Smith

Ms. Maria Spagnuolo
Ms. Susan F. Starr
Mr. and Mrs. David R. Strange
Mr. and Mrs. Phillip Sullivan, Sr.
Ms. Karen Taylor
Trader Joe's
Vertex Fitness
Meredith and Gregory Waldron
Walter J. Cook Jeweler, Inc.
White Manor Country Club
Mr. and Mrs. Bradley L. White
Mr. and Mrs. Charles K. White
Mr. and Mrs. Thaddeus
Zettlemoyer

Gifts in kind are especially welcome to help provide every Inglis resident with a gift at the holidays. Donations of new toiletries, costume jewelry, zip-front sweatshirts, winter hats, scarves and gloves, are most appreciated.

this newsletter or visit www.inglis.org to make your contribution.

Memorial and Tribute Gifts

Many friends of Inglis make donations in honor of or in memory of friends and family. In commemorating a loved one, these thoughtful gifts enrich many lives in the Inglis Community.

Gifts in Honor of

Linda A. Aghoian	Thomas Hennessey	Kristen Lech	Lucia Quinn
Arlene J. Baker	Dana Hirsch	Robert L. Leopold, MD	Mark A. Ramsey
Virginia Bennett	Barbara Hnizdo	James G. Logue, Esq.	Geela R. Raphael
Marsha E. Brown	Ellen Hunter	Gabriel Maioriello	Deanne Z. Sawers
Harriet P. Brown-Schlagle	Victoria Jefferson	Betty J. Marmon	Ann F. Schellenger
Tanya J. Callihan	Judith L. Jones	Eileen McBreen	James Schiavo
James Caras	Anne Keenan	Rita E. McGinley	Deborah A. Stokes
Barbara H. Carper, CPA	Joyce Kensey	William McGoldrick	Jill P. Stone
Eric Childress	Gavin Kerr	Georgina Minter	Charles R. Tait
Marie Connolly	Anne G. Klaus	Ilene A. Myers	David A. Walker
Lauren E. DeBruicker, Esq.	Jamie Kline	Yuri Neimeyer	Ian C. Zavodnick
Karen Garnett	Jean M. Knowlton	Stephanie Pearce	Inglis House Residents
Mary Anne Gaul	Levis Kochin	Willie Peterson	The Inglis 3 South Community, including residents and staff
Kenneth Harris	Eileen Korey	Richard V. Pinera, III	
	Sharon Lamb	Michael E. Plavcan	

Gifts in Memory of

Anthony D. Abriola	Lisa C. Golden	Michael Meltser	Kenneth Schlagle
John F. Adkins	Carl Goldenberg	John Merkins, Jr.	Lawrence Schoenfeld
Patricia Aron	Fred H. Hirsch	Andrew Merlino	Marilyn Seidman
Ellen D. Asher	Andrew M. Hunter	Carl B. Metzger, III	Diana J. Serviss
Catherine Bates	Barbara S. Hyde	Adelene B. Miller	John J. Shawaryn, Jr.
Lucille Biron	Nicholas F. Ide	Linda M. Miller	Joseph F. Shore
Marvin Blum	Donna M. Johnson	Robyn Monahan Spindel	Kirk H. Smith
Dennis Bralow	Thomas Johnstone	Marc A. Moss	Wanda Smith
Anne J. Brown	Coryne Jones	Robert C. Mowry	Anita Spiegel
Rosemary A. Campbell	Joseph M. Jones	Charles Myers, Jr.	Steven H. Starr
John D. Carre	Melody Jones	Robert Nolan	Louis J. Steffa
Emilio Cicchetti	David Jones	Ellen and James Ounsworth	Donald Sugarman
Floyd Clark	John Jones	Josephine Panunto	John H. Swarr, Jr.
Barbara Clayton	Thelma Jones	Joan E. Pasternack	Edwin H. Taxis
Mrs. Comerford	Cathy A. Kaseman	Margaret Patterson	Jean Tomasetti
Peggy Crocco	Joan M. Kling	Donna R. Pickens	Marie Turnbull
Pierce A. Cumings, Jr.	Helene Kuchin	Carmen Pitoscia	Carl Van Fleet
Andrew Duckenfield	Paul B. Kuper	Doris M. Reilly	Ms. Vernot
Maryann Esposito	Doris D. Levister	William Reisser	Kenneth Wainwright
Mary Ann Farrell	Mary J. Long	Linda Rojahn	Ben Weidman
Joan M. Feliton	Deloris Majett	Herbert Rosenberg	Beatrice Wexler
Ellen and Jack Fitzgerald	Angelina Manniso	Joan Rosenbloom	John A. Whereat
Mary Ford	Eleanor Marra	Karen Rotondo	Gus Woehr
Robinson Fredenthal	James R. McFarland, Sr.	Margaret E. Russell	Bernard Woldar
Nichole D. Gaskins	Betty O. McGee	Alice Ryan	
	Esther Medoway	Rosamond J. Sanderson	
		Harvey T. Sayen, Jr.	

The contributions of the generous donors listed throughout were received between July 1, 2013 and June 30, 2014. While this list reflects gifts of \$100 or more, Inglis greatly appreciates the dedicated donors who support us at all levels.

We have carefully reviewed all names. However, if your name has been accidentally misspelled or omitted, please call Meredith Quirin Waldron, Director of Development, at (215) 581-0703 or send an email to meredith.waldron@inglis.org.

Inglis Holiday Wish List Your gift helps year-round!

Few people realize that Medicare and Medicaid cover only the very basics of each resident's care at Inglis. All of the rest—social and recreational activities, computer training, special equipment and even the beautiful therapeutic garden in our courtyard—are made possible through the generosity of our donors.

The following “wish list” items will further enhance the lives of the Inglis Community. If you're unable to purchase an item by yourself, consider holding a fundraising drive at your school or place of business. Individual donations of any amount are gratefully accepted, too.

Social Enrichment Parties

One of the major reasons that people choose to live at Inglis House is our active daily roster of social and recreational activities. Major seasonal events like our Harvest Ball, Spring Fling, New Year's and Valentine's parties provide a welcome “night out” for residents complete with a festive menu and live entertainment.

**Cost: \$1,000 per event;
\$5,000 for the year**

Technology

Gifts to our Adapted Technology Fund provide life-changing technical support and training. **Consider making a gift of any amount** to help our residents connect with friends and family via the internet, read a book independently or find joy in computer art or other hobbies.

Aquarium

An aquarium brings the serenity of nature indoors. Watching colorful fish swim relieves stress, plus the gurgling sound of the bubbles adds to the therapeutic effect.

Cost: \$3,000

Sporting events

Inglis House residents are among the most loyal Phillies, Eagles, Flyers and 76ers fans. A day at the ballpark or sports arena is high on the list of favorite activities.

Cost: \$750 for tickets and transportation for six residents and their attendants

Sky Panels for the Inglis Day Program

People with developmental or cognitive disabilities typically struggle with sensitivities to bright or harsh lighting. A row of sky panels in our program space would diffuse the light and make the room feel more inviting.

Cost: \$57 per panel (six needed)

Fiber optic spray lights for the Inglis Day Program

People who have limited ways of participating in activities can be readily engaged with sensory stimulation. Fiber optic spray lights provide fascinating sparkle effects and have been shown to enhance relaxation, concentration, communication and general awareness of the surrounding world.

Cost: \$1,300





**Ability &
Independence.
Redefined.**

2600 Belmont Avenue
Philadelphia, PA 19131

NON-PROFIT
U.S. POSTAGE
PAID
PERMIT NO. 1102
PHILADELPHIA, PA

Inglis website receives two awards

Since Inglis launched its new, fully accessible website in May 2013, Inglis.org has received two prestigious industry awards: **Best Website from PR Daily's 2014 Nonprofit PR Awards**, and a **2014 Summit International Creative Award**.

PR Daily selected the website for top honors for its elegant, clean and dynamic design. They also lauded its accessibility for visitors and programmers with disabilities. Says PR Daily, "The result is a website that looks great, serves the needs of stakeholders, and is accessible without showing its 'nuts and bolts.' Increased visits, reduced bounce rates, and increased web donations testify to its effectiveness."

Inglis also received a Summit International Creative Award, which recognizes companies worldwide for innovative and leading-edge creative work. The international marketing organization receives some 5,000 submissions from 24 countries.

The Summit Awards committee also noted our website's design and accessibility features, highlighting its function, form and ease of use.



Congratulations to Inglis Marketing Director Gary Bramnick, our webmaster Eliot Spindel and King Design of Jenkintown, PA, who have been instrumental in the success of the website.

What do you think our new *Image?* Please let us know at info@inglis.org